

Platinum Series Six Shooter

Product Manual



PROUDLY
MANUFACTURED IN
THE U.S.A.

Table of Contents

Welcome iii
 Contact Us..... iii
 Mr. Manhole Parts Warranty iii

Safety Summary..... iv
 Warnings and Cautions iv
 Warning and Caution Statement Definitions..... iv
 Note Statements iv
 Note Statement Definition iv

General Safety Precautions..... v

Lifting Precautions vi

Overview and Specifications 1

Six Shooter Operation Overview..... 2
 Skid Steer Loader Requirements 2
 Operational Overview 3
 Six Shooter Part Numbers..... 3
 Speedplate (Standard) Part Numbers..... 4

Unpacking and Assembling Instructions

Before You Start 5
 Unpacking and Assembling Instructions..... 6
 Unpacking the Platinum Series Six Shooter..... 7
 Setting Cutting Diameter 12
 Using Included Accessories 13
 Standard Speedplate 13
 Casting Lifter 16
 Lifting Magnet 16

Optional Parts and Accessories17

- Extended Guide Shaft Platinum Series 51"..... 17
- Manhole Rebuild Package..... 17
- Mark Rite Tool 18
- Water Valve Rebuild Package 18
- Water Valve Underslung Arm 19
- Water Valve Cutting Blade (Teeth Included)..... 19
- Mr. Valve Centering Cone & Reducer Ring.....20
- Mr. Valve Blaster Unit.....20
- 6" Extended Blade Assembly - Platinum (Teeth Included)20
- Lifting Device.....21
- Newcon Plate, Pipe Guide, and T-Stop.....21
- Newcon Auger21

Product Registration Form.....22

Welcome

WELCOME

Congratulations on your purchase of the Platinum Series Six Shooter Customer Package. The Platinum Series Six Shooter is the latest in manhole repair technology, specifically crafted for high-volume repairs with increased power, speed, and durability.

This product manual contains complete instructions for unpacking and setting up the Six Shooter and the included components, as well as a parts and accessories guide for the optional items available for use with the Six Shooter.

It is extremely important to be aware of the precautions necessary for safe and proper use of this equipment. The Safety Summary contains an explanation of the warning and caution statements found throughout the manual, a list of general precautions, and a guide to recommended lifting methods.

Make sure that all operators study this manual carefully and keep it on file for future reference. Operators should also view the training instructions in the Video Resources section of www.mrmanhole.com.

Contact Us

We strive to provide superior products and the highest level of customer service. If you have any questions about your Platinum Series Six Shooter purchase, or any of our products, please contact Mr. Manhole.

Phone: 567-242-2221 • Fax: 419-692-1600 • Email: info@mrmanhole.com

You may also visit the Video Resources section of www.mrmanhole.com for demos of the Mr. Manhole parts and accessories.

Mr. Manhole Parts Warranty

The following Platinum Series Six Shooter, Gold Series Six Shooter and B-52 Cutter components will be warranted to be free from structural defects for a period of One Year from the Date of Purchase:

Part Description	Platinum Series Six Shooter Part #	Gold Series Six Shooter Part #	B-52 Cutter Part #
Top Drive	K-MM0369	K-MM0374	K-MM0371
Main Frame	K-MM0550	K-MM0549	K-MM0551
Bottom Drive	K-MM0370	K-MM0370	K-MM0370
Arms	P-MM0107	P-MM0018	N/A
Legs	A-MM0118	A-MM0013	A-MM0013

The above list includes all the Mr. Manhole parts that are warranted. All other products carry no warranty. All components that are to be replaced under warranty must be returned to the manufacturer in an unrepaired state. If the component has been repaired or modified in any way, the warranty is void. It is the responsibility of the purchaser to return defective parts to the manufacturer at: 125 South Canal Street, Delphos, Ohio 45833. You will be invoiced for the replacement item(s) and a credit will be issued upon receipt of the defective item.

Warranties are valid only for the original owner of the equipment and are non-transferable. Warranties apply from the Date of Purchase from Mr. Manhole and/or authorized distributors. The Product Registration Form must be received within 30 days of the purchase date, accompanied by the original sales receipt.

Safety Summary

Warnings and Cautions

Warning and caution statements are placed throughout this manual prior to procedures, practices, and/or conditions that could be hazardous to operators or could cause damage to equipment.

Operators must understand and apply the applicable safety precautions during all phases of equipment assembly and operation.

Be sure to review all warning and caution statements prior to set up and operation of the Six Shooter.

Warning and Caution Statement Definitions



WARNING: Operating procedures, practices, or conditions which could result in injury and/or loss of life if not strictly observed.



CAUTION: Operating procedures, practices, or conditions which could result in damage to, or destruction of equipment if not strictly observed.

Note Statements

Note statements are placed throughout the manual prior to procedures, practices, and/or conditions with information that is necessary for the operator to know before proceeding.

Note Statement Definition

NOTE: Information pertaining to operating procedures, conditions, and other factors that is necessary to know before proceeding.

General Safety Precautions

You must read and understand the entire manual before unpacking and assembling the Six Shooter and its components. Follow industry safety precautions and pay particular attention to Warning and Caution statements. See your supervisor for guidance if any questions arise.



WARNING: The following general safety precautions are to be followed at all times while operating the Six Shooter. These precautions will ensure personal safety and protection of the equipment. Failure to observe these safety precautions can result in death, serious injury, or serious equipment damage.

- Keep bystanders a minimum of 20 feet away from the working area of the Six Shooter. Stop operation immediately if anyone enters this perimeter.
- Locate underground electrical wires, telephone cables, and gas, water, and sewer lines before digging. Maintain safe clearance and avoid contact with any underground or overhead utility lines or electrically-charged conductors.
- Wear protective clothing and equipment (gloves, eye protection, and other items as appropriate) approved for the equipment and tools being used. Contact your supervisor for guidance.
- Do not wear any loose-fitting items such as clothing or jewelry. Moving parts can catch on loose fitting items.
- Operators must not use drugs or alcohol prior to use of this equipment. An operator taking prescription or over the counter drugs should seek medical advice before operation.
- Never alter or remove any safety decals or safety shields. Check the equipment for location of these items and replace immediately if damaged or illegible.
- Do not attempt service or adjustment of equipment unless another person capable of rendering aid is present.
- Whenever changing or installing any component of the Six Shooter , make sure all connections are securely fastened.
- Avoid steep hillside operation, which could cause the vehicle carrying the Six Shooter to overturn. Consult the vehicle operation and safety manuals for the maximum incline allowable.
- This manual covers the safe unpacking, set up, and installation instructions for the Six Shooter only. Always read the operation and safety manuals prepared for the vehicle and any other attachments before using them.

Lifting Precautions



WARNING: Failure to follow recommended handling/moving procedures could result in serious personal injury, death, or damage to the equipment. Improper handling of the Six Shooter is a lifting hazard. Failure to use the proper lifting method may result in serious personal injury.

If possible, operators should limit lifting to no more than 50 pounds. When lifting loads heavier than 50 pounds, use two or more people to lift the load.

The following table lists the major components of the Platinum Series Six Shooter package, with equipment weights and recommended lifting methods:

Equipment Weights and Lifting Methods		
Part Name	Weight (lbs)	Recommended Lift Method
Platinum Series Six Shooter	1,400	Mechanical lift
Heavy Duty Auger Drive Model 40 2.5" Hex Drive	485	Mechanical lift
Standard Speedplate	85	2-person/mechanical
Standard Guide Shaft Platinum Series 39"	49	1-person
Casting Lifter Bracket - Platinum Series	22.5	1-person
Extended Guide Shaft Platinum Series 51"	64	2-person/mechanical

Overview and Specifications

The Platinum Series Six Shooter Customer Package (K-MM0098) contains: [See Figure 1.](#)

- Platinum Series Six Shooter
- Heavy-Duty Auger Drive Model 40 2.5" Hex Drive [P-MM0070]
- Standard Speedplate [A-MM0130]
- Spare Parts Repair Kit [A-MM0147]
- Lifting Magnet [K-MM0045]
- Casting Lifter Bracket - Platinum Series [A-MM0078 - PLATINUM]
- Quick Change Teeth Gun Kit [A-MM0084]
- Debris Shield [A-MM0363]
- Extended Guide Shaft Platinum Series 51" [K-MM0513]
- Safety Bar [A-MM0065]
- 1 Bag Of Carbide Teeth And Roll Pins (24) [P-MM0026]

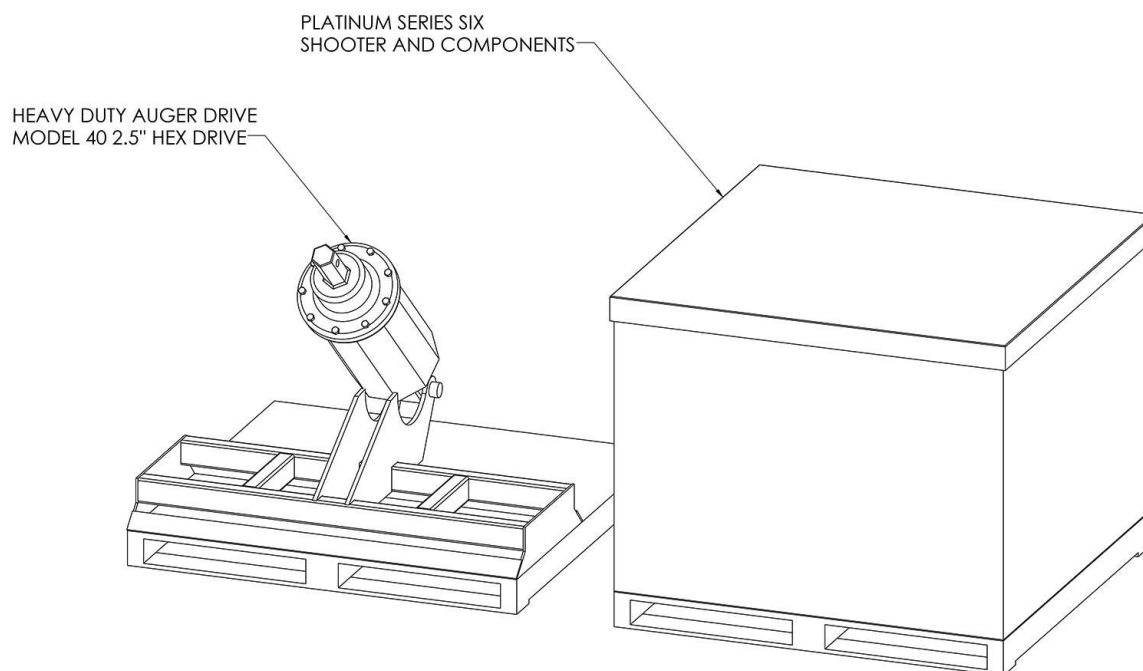

Figure 1. Platinum Series Six Shooter Package

Six Shooter Operation Overview

The Six Shooter cutting system runs on a heavy-duty auger drive, which is fed through the auxiliary hydraulic circuit of a skid steer loader with included hydraulic hoses. As the Six Shooter rotates, six Cutting Arms, each equipped with four replaceable carbide teeth, cut through concrete and asphalt without needing water or coolant. The carbide teeth can be replaced in minutes, even on the job site.

NOTE: The Six Shooter is designed to bounce up and down during operation, similar to a hammer drill. This motion increases its cutting ability.

The Six Shooter features an adjustable cutting diameter from 50 to 72 inches. The Cutting Arms are easily adjusted on the job site without extra tools. The blades have a cutting depth of 16 inches, or up to 22 inches with the optional 6" Extended Blades - Platinum (Teeth Included) [A-MM0422]. If necessary, use the optional Water Valve Rebuild Package [K-MM0325] to cut out water valve boxes.

For a complete list of the optional accessories available for the Six Shooter, see the Optional Parts and Accessories section in this manual, or visit www.mrmanhole.com.

Skid Steer Loader Requirements

The Six Shooter attaches to your skid steer loader via a custom-built Heavy Duty Auger Drive Model 40 2.5" Hex Drive [P-MM0070]. The design allows the operator to see the work in progress during use of the Six Shooter. See [Figure 2](#) below.

The skid loader must have 2,500 lbs minimum lifting capacity.

The skid loader must be capable of providing at least 20 gpm hydraulic flow. The flow determines the rpm of the Six Shooter, so a higher gpm flow translates to faster cutting speed. It is a plus for the skid loader to have a high flow hydraulic circuit generating 30-45 gpm flow.

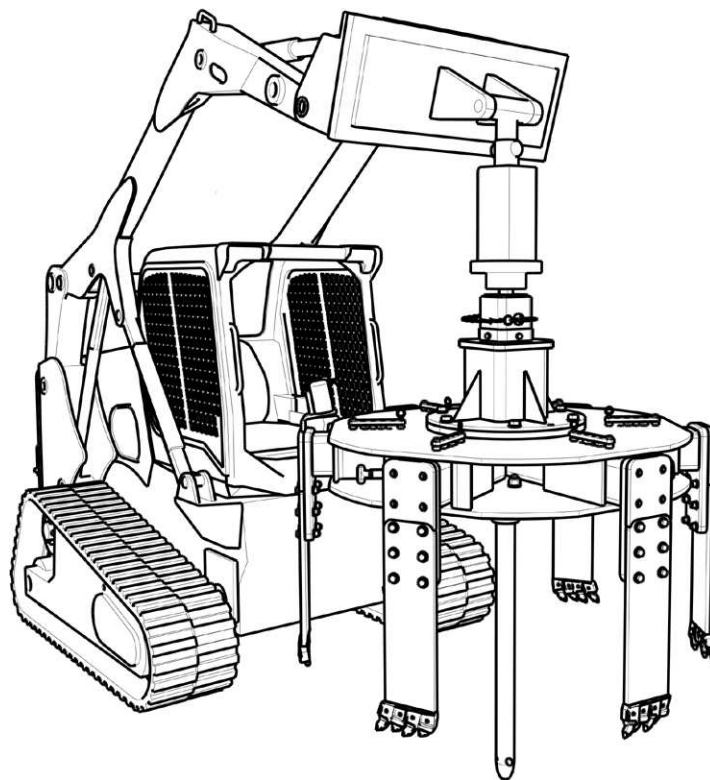

Figure 2. Skid Loader with Six Shooter Attached

Platinum Series Six Shooter

The Six Shooter unit is the heart of the Mr. Manhole system.

The Six Shooter has six Cutting Arms and six cutting Tooth Blades that are each armed with four teeth, mounted to the circular Main Frame. The Six Shooter attaches to a heavy-duty auger drive via the Easy Drive Top.

See [Figure 3](#) for a detailed illustration of the components of the Six Shooter.

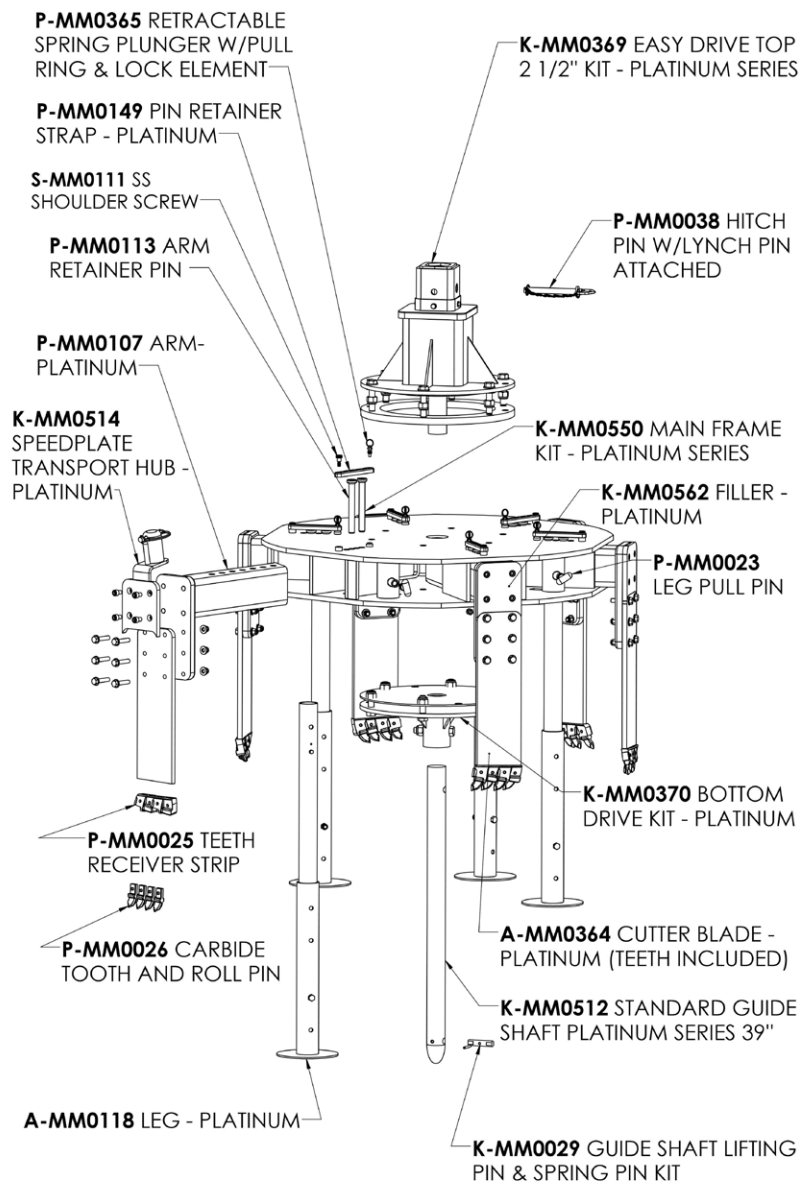

Figure 3. Six Shooter Components

Standard Speedplate Part Numbers

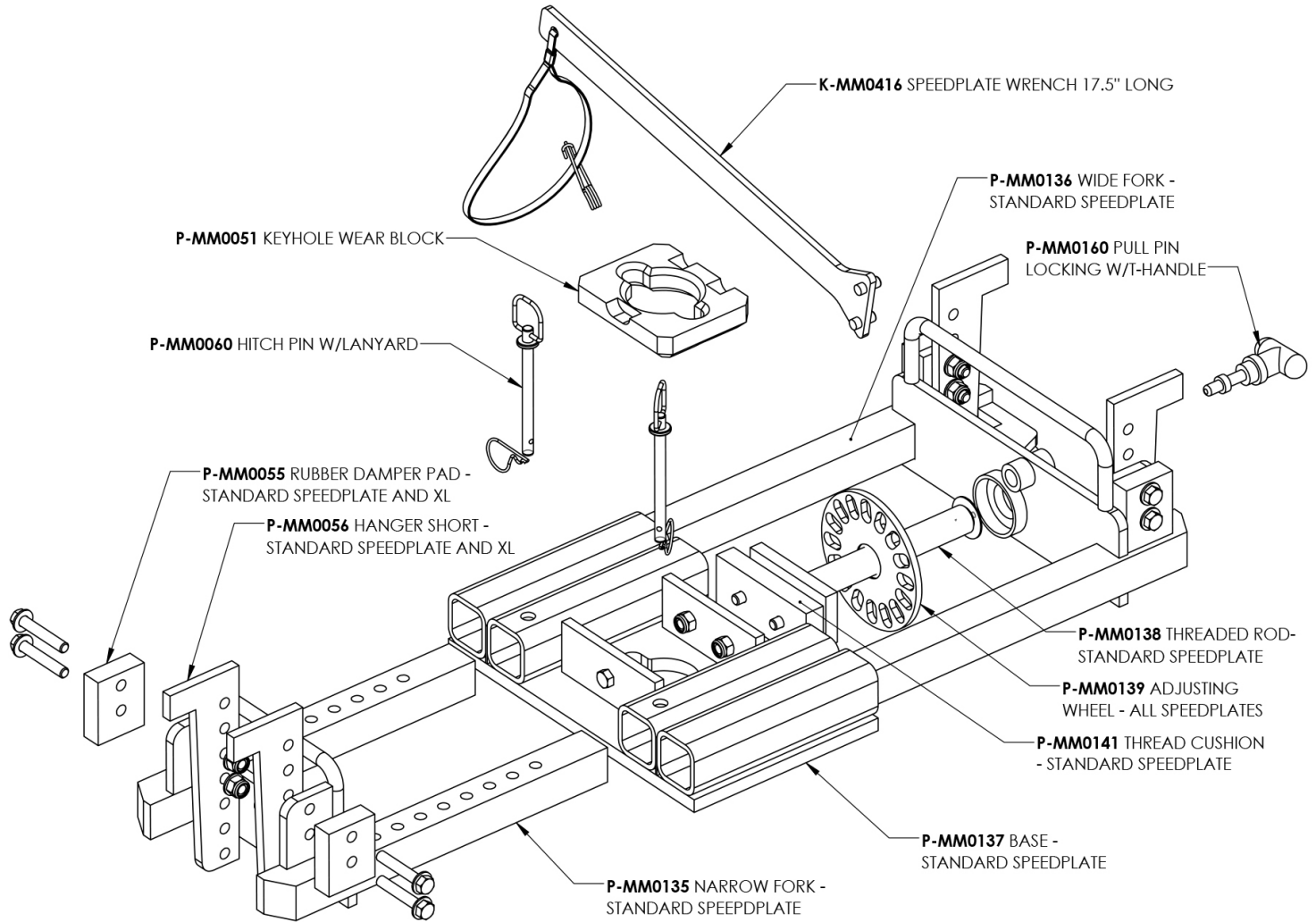

Figure 4. Standard Speedplate Parts

Following are the components of the Platinum Series Six Shooter with part numbers and weights:

Platinum Six Shooter Parts List		
Part Name	Part Number	Weight (lbs)
Easy Drive Top 2 ½" Kit – Platinum Series	K-MM0369	221 lbs
Main Frame Kit – Platinum Series	K-MM0550	725 lb
Arm – Platinum (6)	P-MM0107	339 lbs
Cutter Blade – Platinum (6)- (Teeth Included)	A-MM0364	150 lbs
Carbide Tooth And Roll Pin (24)	P-MM0026	10 lbs
Arm Retainer Pin (12)	P-MM0113	12 lbs
Leg – Platinum (4)	A-MM0118	98 lbs
Standard Guide Shaft Platinum Series 39"	K-MM0512	49 lbs
Bottom Drive Kit	K-MM0370	56.5 lbs
Filler – Platinum (6)	K-MM0562	6.5 lbs
Pin Retainer Strap – Platinum (6)	P-MM0149	.5 lbs
Retractable Spring Plunger With Pull Ring & Lock Element (6)	P-MM0365	1 oz
Speedplate Transport Hub - Platinum	K-MM0514	14 lbs
SS Shoulder Screw	S-MM0111	.25 lbs

Before You Start

Clear the area around the Six Shooter shipping container for the unpacking and set-up process. You will need a forklift capable of lifting up to 2,500 pounds. You will also need the skid steer loader with the auger drive attached.

NOTE: The Heavy Duty Auger Drive Model 40 2.5" Hex Drive [P-MM0070], included in the Platinum Series Six Shooter system, is shipped separately and arrives on a pallet. See the Hydraulic Drive Unit Operator's manual for the complete instructions for attaching the auger drive to the skid steer loader.

Unpacking and Assembling Instructions

This section contains instructions for unpacking and assembling the Six Shooter. After completing these instructions, the Six Shooter will be ready for use.



WARNING: Some components/elements of the Six Shooter system present a lifting hazard if not handled correctly. Failure to use the proper lifting method may result in serious personal injury. Refer to Table 1, Equipment Weights and Lifting Methods.



CAUTION: Be sure to wear protective clothing, such as gloves and steel-toed boots, approved for the equipment and tools used when unpacking and setting up the Six Shooter.

NOTE: You will need the following tools to unpack and set up the Six Shooter:

Required Tools List
Heavy-duty lifting strap with 2,000 lb lifting capacity
1-1/16 inch wrench
1-1/8 inch socket
3/4 inch socket
3/4 inch wrench
Banding cutter (to cut packing bands)

The Platinum Series Six Shooter package includes the following hardware:

- (36) 1/2-inch x 13 x 2 1/2 inch grade 8 bolts
- (36) 1/2-inch Grade 8 nylock nuts
- (72) 1/2-inch Grade 8 washers

Unpacking the Platinum Series Six Shooter

Unpack the Six Shooter in a central area where a forklift and skid steer loader can be used. Before proceeding with assembly, inspect the package and check the packing sheet/inventory of contents. Contact Mr. Manhole immediately if anything is missing.

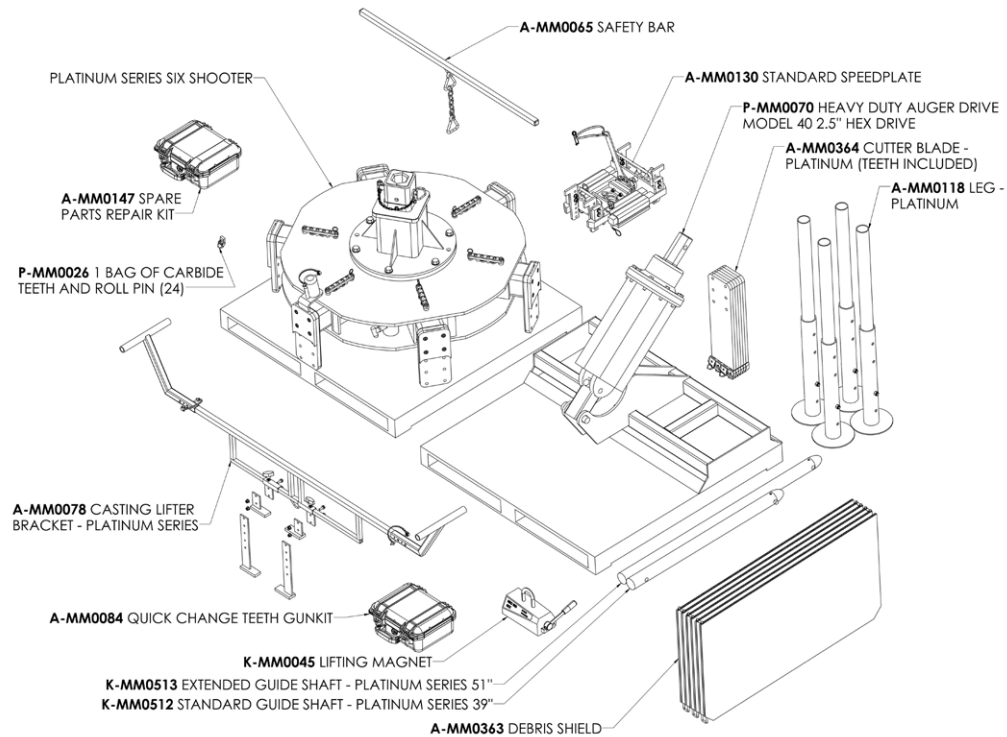

Figure 5. Package Contents

1. Remove the items from the top of the shipping container. See Figure 5. Pull the hitch pin out of the Easy Drive Top on the Six Shooter and insert the lifting strap into the hole in the top of the Drive Unit. Reinsert the hitch pin through the strap.



CAUTION: The Six Shooter presents a lifting hazard if not handled correctly. Use the proper lifting methods for handling all components of the Six Shooter System.

2. Loop the lifting strap onto the blades of the fork lift.
See Figure 6.
3. Using the lifting device, lift the Six Shooter straight up out of the shipping container and back away from the container.

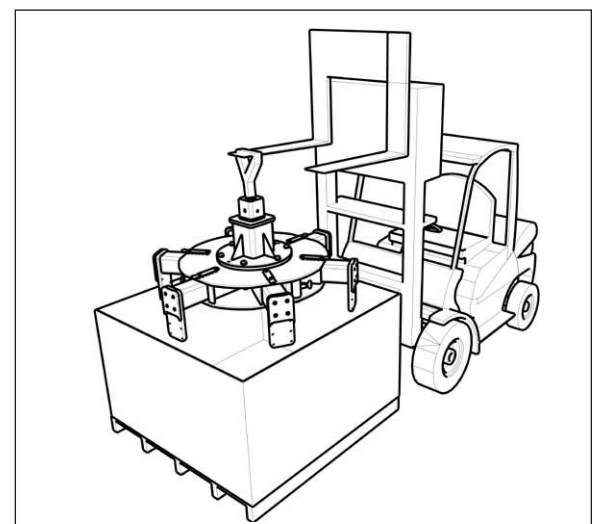

Figure 6. Use A Lifting Strap

4. The Six Shooter must remain suspended to attach the Supporting Legs. [A-MM0118]
5. Remove the four Supporting Legs from the box.
6. Loosen and remove the nut and bolt from the base of the Supporting Leg. Repeat for each leg. See [Figure 7](#).

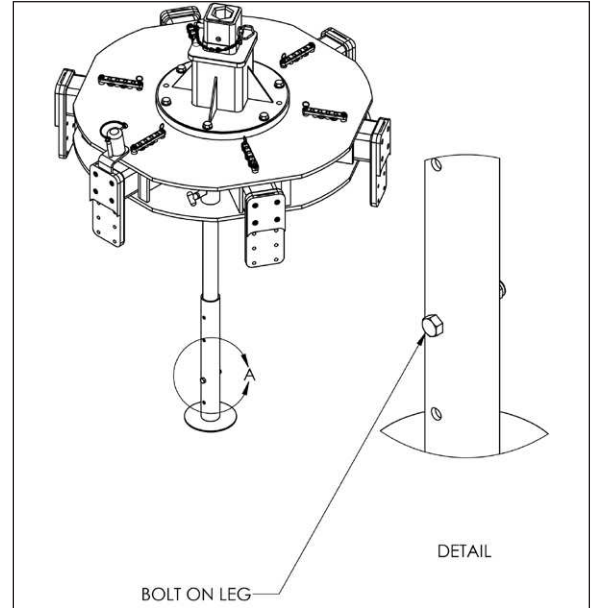

Figure 7. Loosening Bolt On Supporting Leg

7. Extend the Supporting Leg fully and replace and tighten the nut and bolt. Repeat for each leg.
8. While the Six Shooter remains suspended, attach the Supporting Legs. See [Figure 8](#).

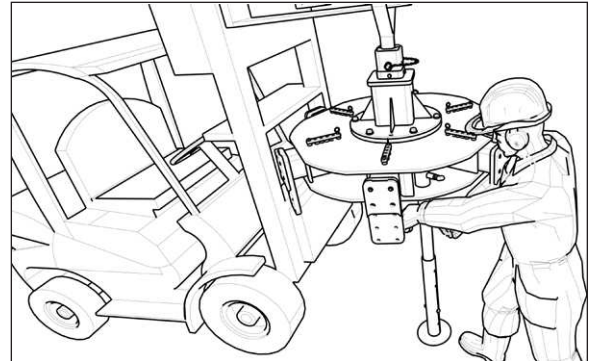

Figure 8. Attaching Supporting Legs To Six Shooter

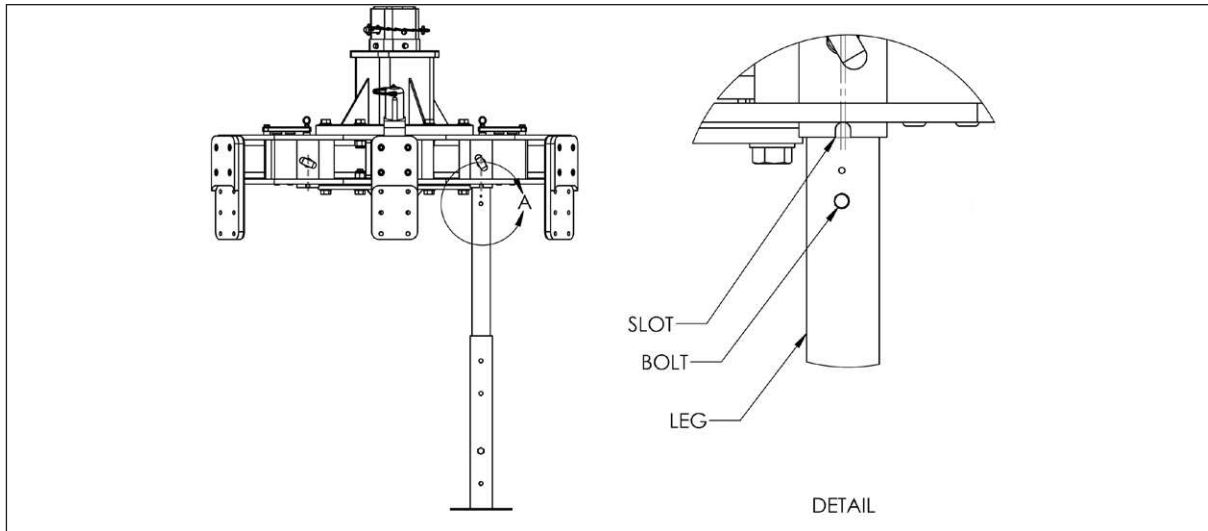

Figure 9. Close Up Of Bolt On Supporting Leg

9. Line up the bolt head with the slot in the leg sleeve, as shown in [Figure 9](#).

10. Pull the Leg Pull Pin [P-MM0023] outward and slide the leg into the sleeve until the Leg Pull Pin is able to snap into the leg hole. See [Figure 10](#).

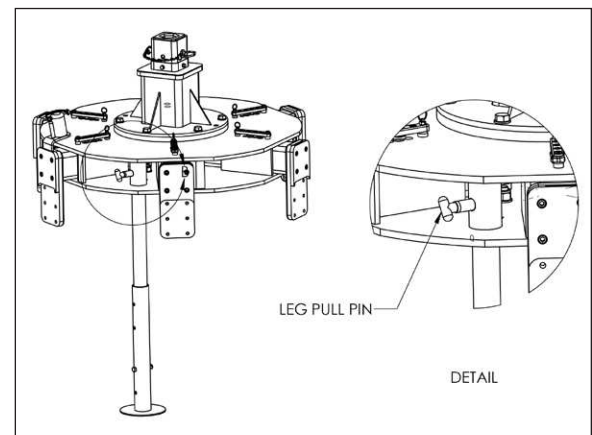

Figure 10. Leg Pull Pin For Leg

CAUTION: Check to make sure the legs are fully attached and seated before lowering the Six Shooter. Leg Pull Pin Locked in Place

11. Lower the Six Shooter to the ground until it is supported by the legs, as shown in [Figure 11](#).

WARNING: The Six Shooter is heavy and could cause severe injury if it falls. Leave the lifting strap attached to the Six Shooter while performing the remaining steps. Leg Pull Pin must be locked in place.

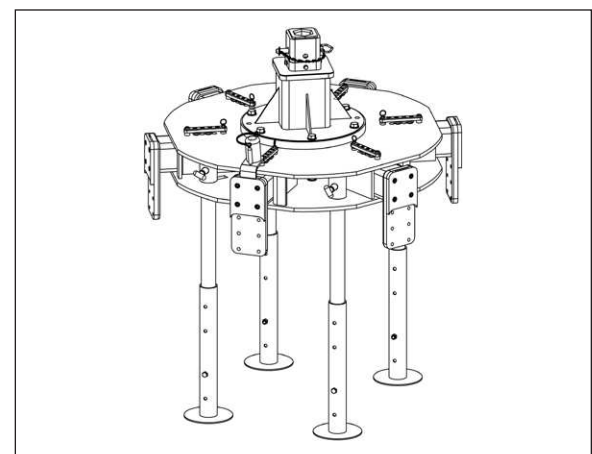

Figure 11. Six Shooter Resting On The Ground

- 12.** Remove the Standard Guide Shaft Platinum Series 39" [K-MM0512] or Extended Guide Shaft Platinum Series 51" [K-MM0513] from the shipping container and remove the bolt from one end. **See Figure 12.**

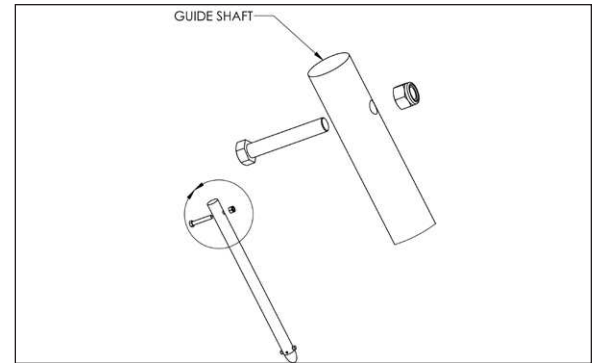

Figure 12. Removing Bolt From Guide Shaft

- 13.** Insert the Guide Shaft into the Bottom Drive of the cutter, being careful to line up the hole in the Guide Shaft with the hole in the Bottom Drive. **See Figure 13.**

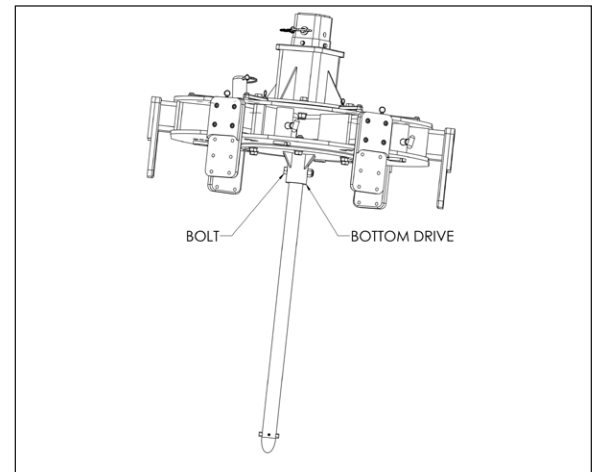

Figure 13. Inserting Guide Shaft Into Bottom Drive Assembly

- 14.** Insert the bolt and securely tighten.
- 15.** Using a 1-1/8 inch socket and a 1-1/16 inch wrench, fasten the bolt through the Center Disc and Guide Shaft.
- 16.** Adjust the supporting legs to MEDIUM height, then lower the Six Shooter to the ground until it is supported by the legs.
- 17.** To maximize space in the shipping container, the Six Shooter is shipped with its Cutting Blades detached. The Cutting Blades must be installed in the operational position before use. To install the Cutting Blades, use the 1/2" bolts (36), nuts (36), and washers (72). Install all 6 Cutting Blades as shown in Figure 14. (One note: As you face the blade, the teeth should point left.) Tools needed for installation: 3/4" socket and 3/4" wrench.

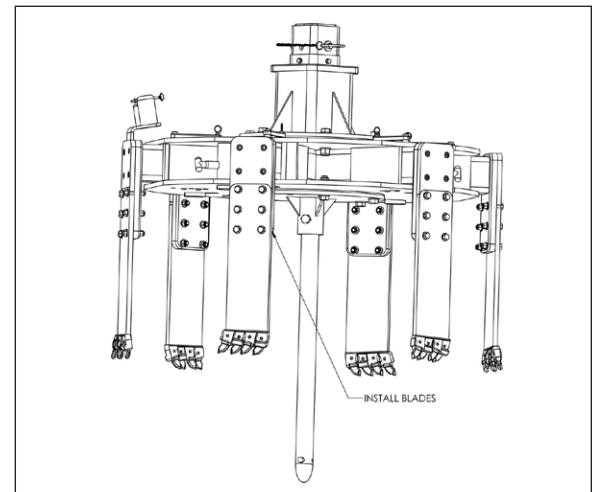

Figure 14. Install Cutting Blades

18. Remove the Arm Retainer Pins [P-MM0113] to adjust the arm position, replace the retaining pins at the desired cutting diameter setting and lock into place. (See Set Cutting Diameter.) See Figure 15.
19. Repeat for each arm [P-MM0107], being certain to adjust all arms to the same cutting diameter.

NOTE: Because the Six Shooter is designed to bounce up and down during operation, similar to a hammer drill, the Cutting Arms will be able to move slightly after being attached.

20. Bring the skid steer loader with the Heavy Duty Auger Drive Model 40 2.5" Hex Drive [P-MM0070] attached to the Six Shooter.
21. Attach the Easy Drive Top [K-MM0369] of the Six Shooter to the Auger Drive, securing it with the provided Hitch Pin With Lynch Pin Attached [P-MM0038]. See Figure 16.



CAUTION: The Hitch Pin With Lynch Pin Attached must be a Grade 8 pin to withstand the stress from picking up the road overcut and the manhole frames. Inspect the pin before every use and frequently during use. Replace pins as they become worn or severe equipment damage may result.

22. Once the Six Shooter is securely attached to the Auger Drive on the skid steer loader, remove the Supporting Legs. [A-MM0118] See Figure 17.



CAUTION: The Supporting Legs must be removed before using the Six Shooter or severe equipment damage may result.

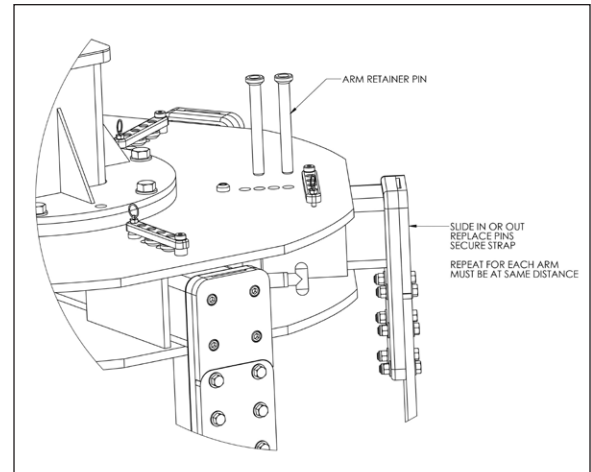

Figure 15. Set Cutting Diameter.

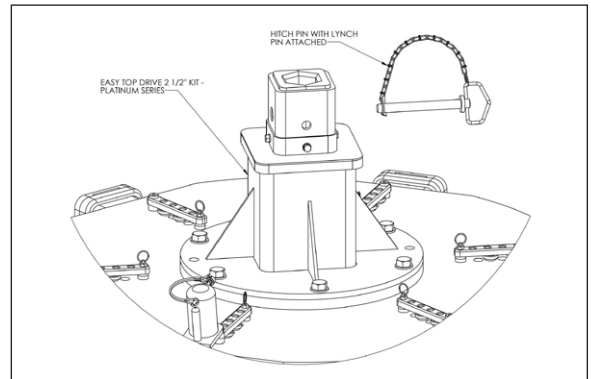

Figure 16. Hitch Pin With Lynch Pin Attached

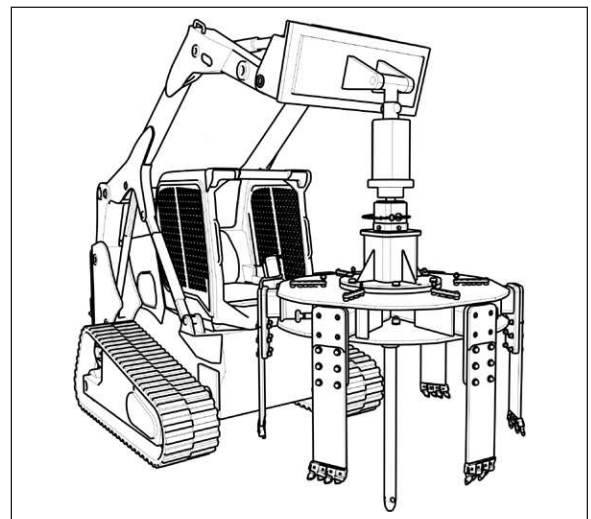

Figure 17. Cutter Attached To Skid Steer

Setting Cutting Diameter

Use the following steps to set the desired cutting diameter of the standard Cutting Arms between 50 and 72 inches. Smaller-diameter cuts (26-34 inches) require the optional water valve repair package.

Cutting Arm Adjustment

Replace the retaining pins at the desired cutting diameter setting and lock into place. Repeat for each arm, being certain to set all arms at the same cutting diameter. See Figure 18.

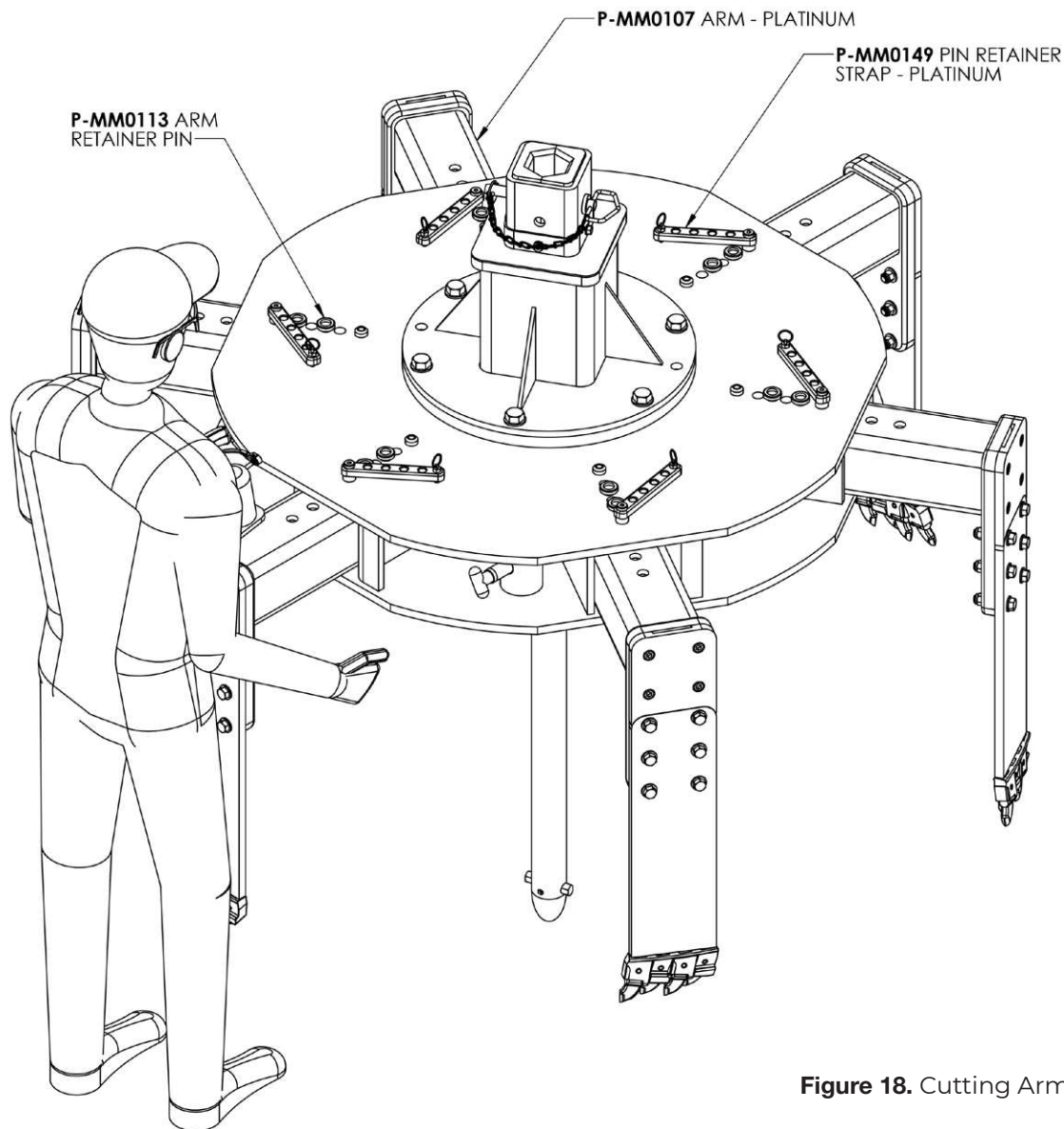

Figure 18. Cutting Arm Adjustment

Using Included Accessories

The Platinum Series Six Shooter Package includes the following accessory items:

- Heavy Duty Auger Drive Model 40 2.5" Hex Drive Assembly [P-MM0070]
- Standard Speedplate [A-MM0130]
- Casting Lifter Bracket - Platinum Series [A-MM0078-PLATINUM]
- Lifting Magnet [K-MM0045]
- Spare Parts Repair Kit [K-MM0147]
- Extended Guide Shaft Platinum Series 39" [P-MM0117]
- Debris Shield [A-MM0363]
- Quick Change Teeth Gun Kit [A-MM0084]
- Safety Bar [A-MM0065]
- 1 Bag Of Carbide Teeth And Roll Pins (24) [P-MM0026]

The following paragraphs contain brief descriptions and set up instructions for the included accessories. Visit the Video Resources section of www.mrmanhole.com for further training instructions and demos of the Mr. Manhole parts and accessories.

Standard Speedplate

Part Number: A-MM0130

Weight: 85 lbs

The Platinum Series Six Shooter Package ships with a Standard Speedplate. See Figure 19.

The Standard Speedplate is able to Accommodate Lid Undercut frames. It fits manhole frames from 19" to 25 ½".

See Figure 21 and 22.

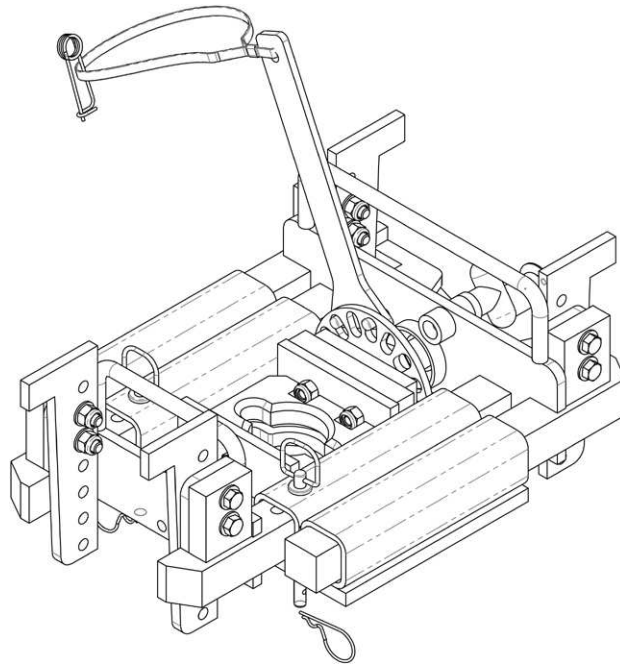

Figure 19. Speedplate And Components

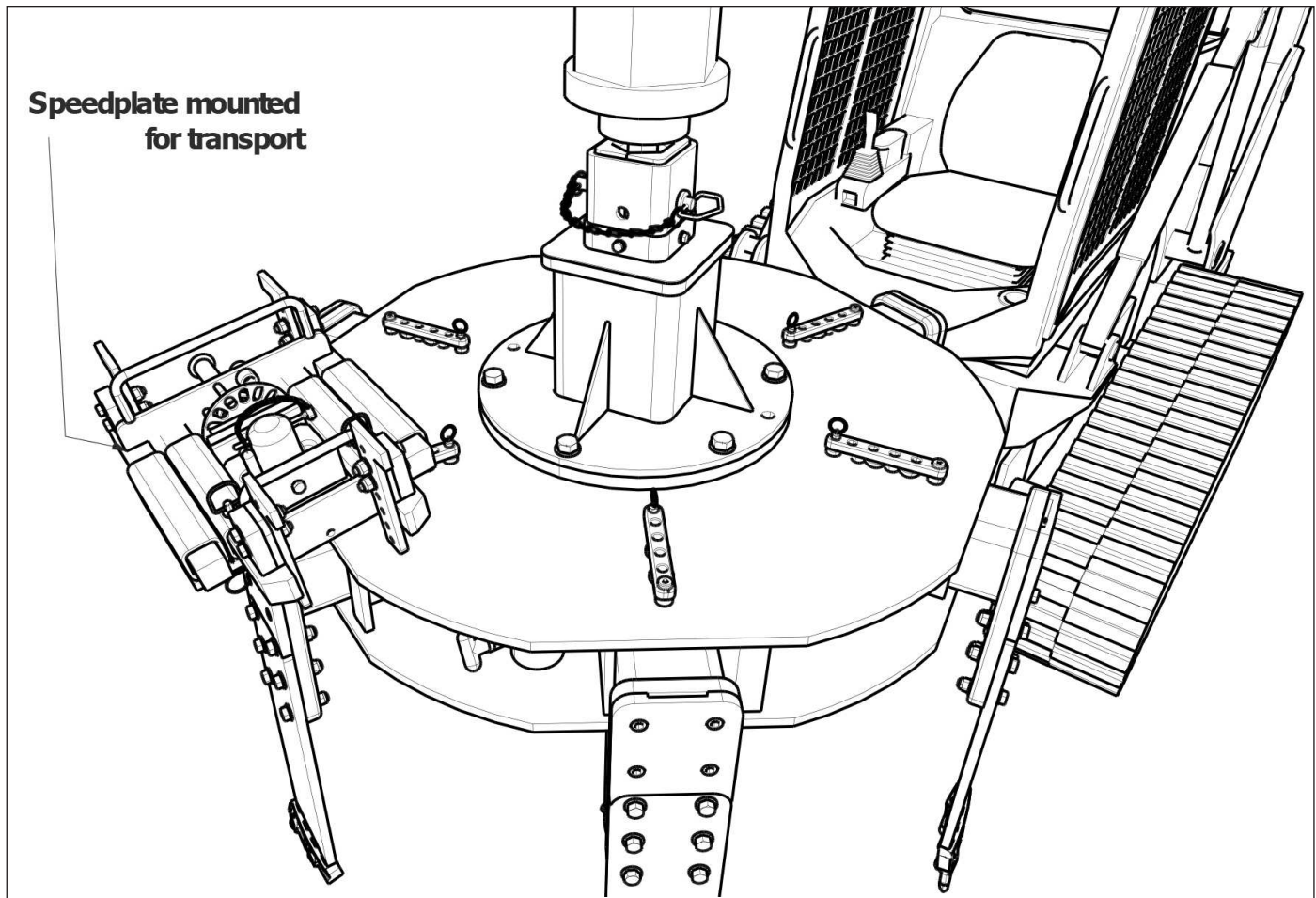

Figure 20. Speedplate can be transported on the built in Speedplate Transport Hub, located on the cutter arm.

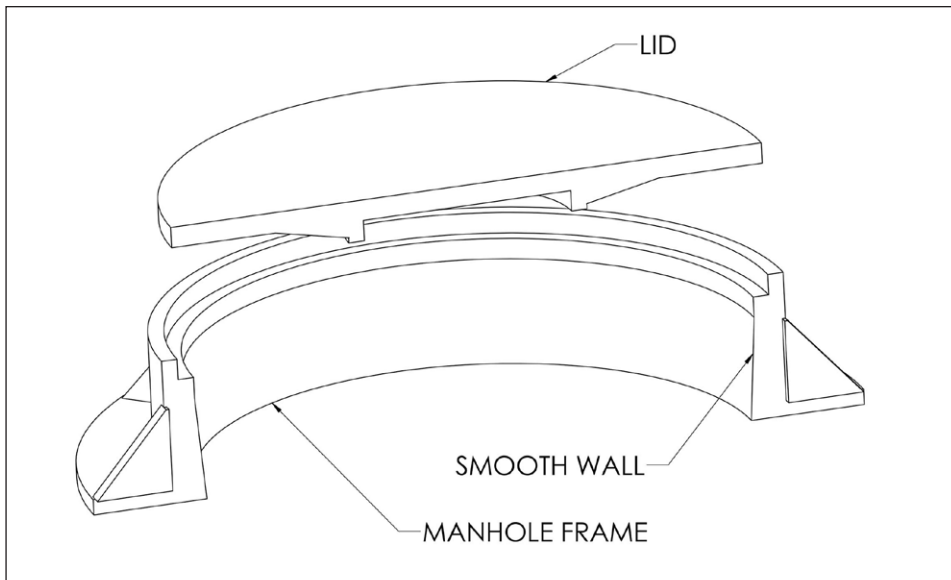
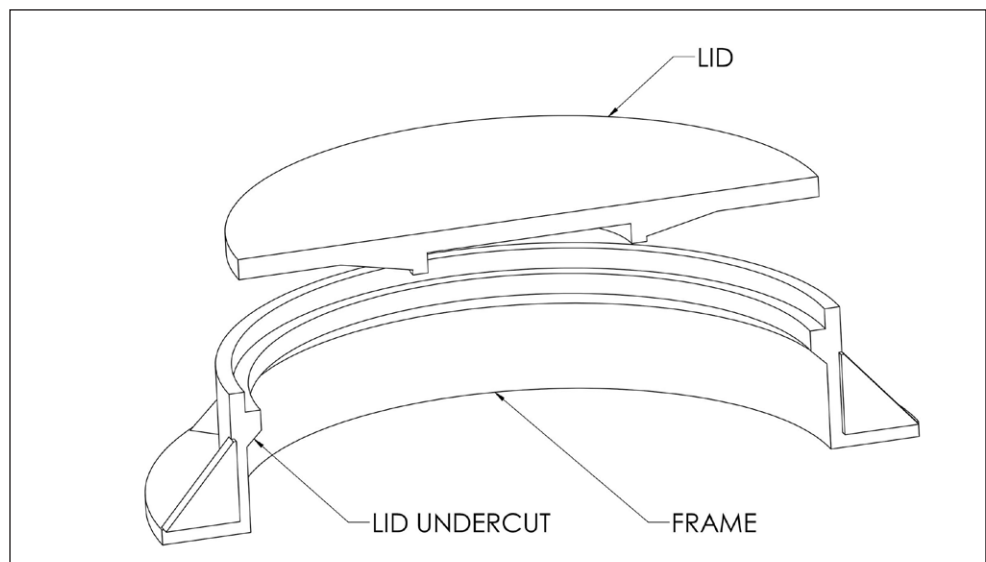

Figure 21. Smooth Wall Style

Figure 22. Lid Undercut



Cutting And Removing

To begin, define your frame style.
See Figures 21, 22.

The two major manhole frame types are the Lid Undercut, (the most popular), and the Smooth Wall. The Standard Speedplate [A-MM0130] is designed to work with the lid undercut manhole frames.

For Smooth Wall frames use the Smooth Wall Speedplate [A-MM0330], which is sold separately. For large diameter manhole frames (over 25 ½" use the XL Speedplate [A-MM0331], which is also sold separately.

To begin the cutting process, select and insert the appropriate Speedplate. Tighten the Speedplate securely in place. Insert the Cutter Guide Shaft through the centering hole in the Speedplate. Erect the Debris Shield. Gently lower the Cutter towards the road and slowly initiate rotation counterclockwise. Engage the road surface and slowly increase rotation speed.

After penetrating the road, ensure the lift pin in the Guide Shaft is transverse to the key shaped centering hole and lift the frame and overcut from the road. Rotate the Cutter to disengage from the frame.

The Casting Lifter Bracket - Platinum Series [A-MM0078-Platinum] is used to lift manhole frames during the rebuilding process. It can be used by two or four men to lift heavy castings. See Figure 23.

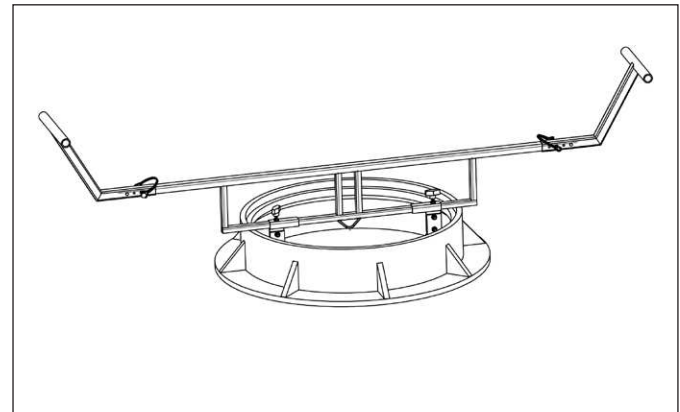

Figure 23. Casting Lifter Bracket - Platinum Series

The Lifting Magnet [K-MM0045] is used to lift manhole lids on and off the frame. See Figure 24.

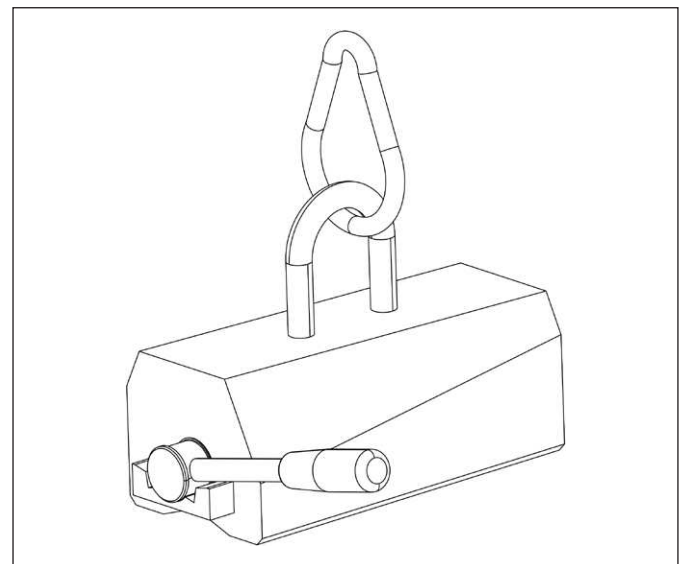

Figure 24. Lifting Magnet

Optional Parts and Accessories

The Six Shooter is a versatile tool with optional parts and accessories designed to handle a variety of manhole and valve box repairs. Contact Mr. Manhole to order any of the optional parts and accessories.

Phone: 567-242-2221

Fax: 419-692-1600

Email: info@mrrmanhole.com

Website: www.mrrmanhole.com

Extended Guide Shaft Platinum Series 51"

Part Number: K-MM0513

Weight: 64 lbs

The Extended Guide Shaft adds up to 12 inches more length than the Standard Guide Shaft and is designed to be used with the Extended Tooth Blades for deeper cutting requirements or with the steel plates used in the new construction method. See the new construction method explained in the video resources page at mrrmanhole.com

The supporting legs of the Six Shooter must be adjusted to their maximum height for installation.

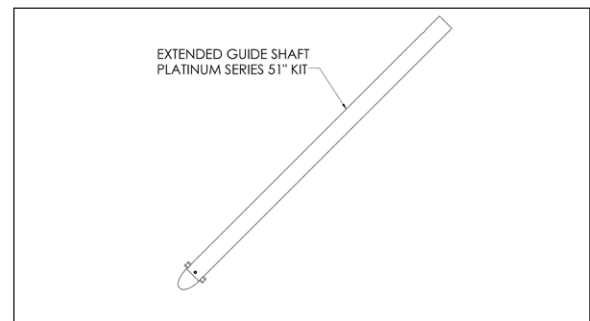

Figure 25. Extended Guide Shaft Platinum Series 51"

Manhole Rebuild Package

Part Number: K-MM0332

Weight 81 lbs.

The Mark Rite Tool [A-MM0304]: Used to mark the manhole chimney liner for a cut to the exact height and slope of the road.

Battery Powered Saw [P-MM0302]: For cutting insert liner material after marking with the Mark Rite Tool. The liner is used to elevate the manhole frame to the proper elevation during the rebuild process.

Battery Powered Sealant Gun [P-MM0303]: For applying Mr. Manhole sealant to liner during the rebuild process.

Wire Tie Tool [P-MM0323]: Used for tying the rebar rings used during the rebuild process.

Measuring Caliper [P-MM0340]: Used to determine the height of the manhole frame and transferring the dimension to the Mark-rite tool.

Concrete Float [P-MM0305]: Used to smooth the concrete during the rebuild process.

Concrete Edger Tool [P-MM0306]: Used to create a rounded edge on the concrete to receive the pourable sealant. The sealant is part of the material package available from Mr. Manhole.

Concrete Finish Brush [P-MM0307]: Used to create the textured finish on the concrete during the rebuild process.

Battery Powered Concrete Vibrator [P-MM0308]: Used to consolidate the ready mixed concrete used in the Mr. Manhole repair process.

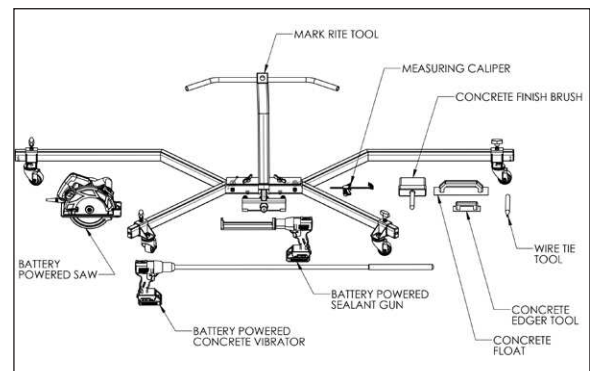

Figure 26. Manhole Rebuild Package

Mark Rite Tool

Part Number: [A-MM0304]

Weight: 50 lbs

The Mark Rite Tool is included in the Manhole Rebuild Package and is the culmination of years of research and design. The tool allows a single operator to easily perform the complex task of accurately marking the insert liner material for cutting. This places the manhole frame exactly level with the height and slope of the road surface every time. The tool can work with large diameter cuts up to 72". The process is quite simple. Simply measure the height of the manhole frame and set the Mark Rite Tool using the installed register. Roll the tool around the liner as it sets on the manhole cone, leaving a distinct line. After marking the liner simply cut it on the line and place the manhole frame on it. Level every time! The Mark Rite Tool is easy to break down into three sections for easy transport. There is no faster or more accurate tool to accomplish a task that used to be very challenging and time consuming. Anyone who has struggled to get a manhole frame level is going to love this amazing tool!

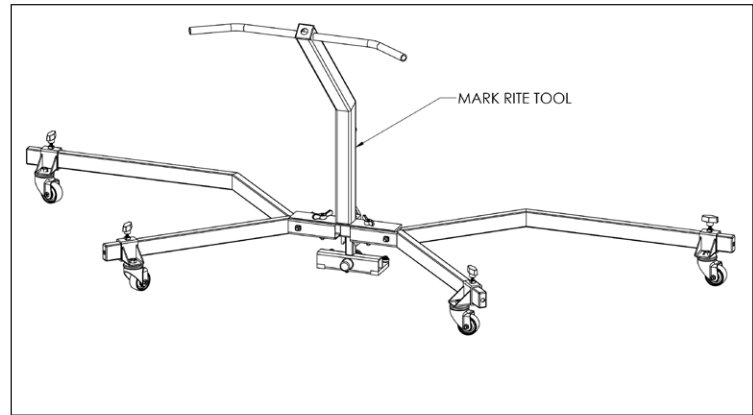

Figure 27. Mark Rite Tool

Water Valve Rebuild Package

Part Number: [K-MM0325]

Weight: 470 lbs

The Water Valve accessories are used in conjunction with the Six Shooter and the Underslung Cutting Arms to cut out and replace water valve boxes. The package includes:

- Water Valve Underslung Arm [K-MM0375]
- Water Valve Cutting Blade (Teeth Included) [A-MM0353]
- Mr. Valve Centering Cone & Reducer Ring [K-MM0173]

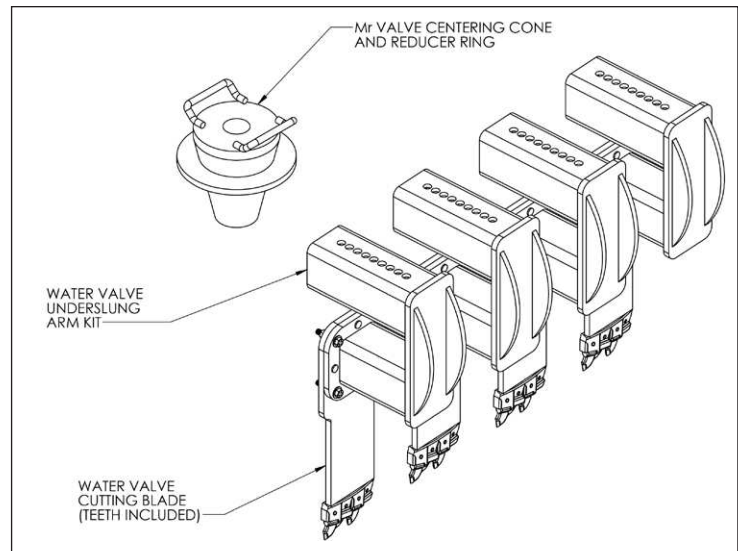

Figure 28. Water Valve Rebuild Package

Water Valve Underslung Arm

Part number K-MM0375

Weight: 94 lbs.

Used for smaller-diameter cuts, such as water valve boxes, the Underslung Cutting Arms are designed to place the Cutting Blades inward, under the Main Frame of the Six Shooter.

Remove all six of the Cutting Arms. Attach the four Underslung Cutting Arms in four of the Cutting Arm slots and fasten with the Retaining Pins in the adjustment holes located on the top of the unit over the adjustable arms. Never use the Underslung Arms with the Speedplate. Use only with the Centering Cone.

The Cutting Blades included in the Water Valve Repair Package have a smaller cutting diameter and are to be used only for small diameter cutting. The Underslung Arms must be used only with the Centering Cone included with the Water Valve Rebuild Package.

* Never use the Underslung Arms with the Speedplate.

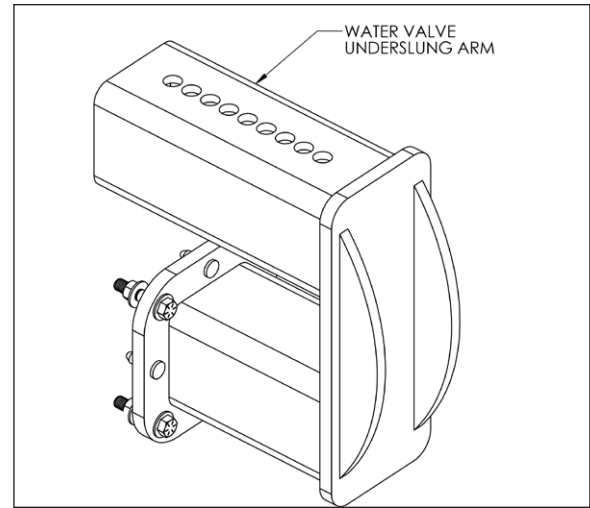

Figure 29. Water Valve Underslung Arm

Water Valve Cutting Blade

(Teeth Included)

Part Number: A-MM0353

Weight: 28 lbs.

Used for cutting small diameter cuts (26"-34"). In conjunction with the Water Valve Underslung Arms.

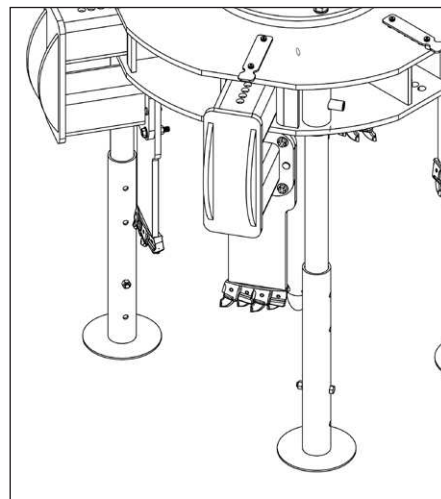

Figure 31.

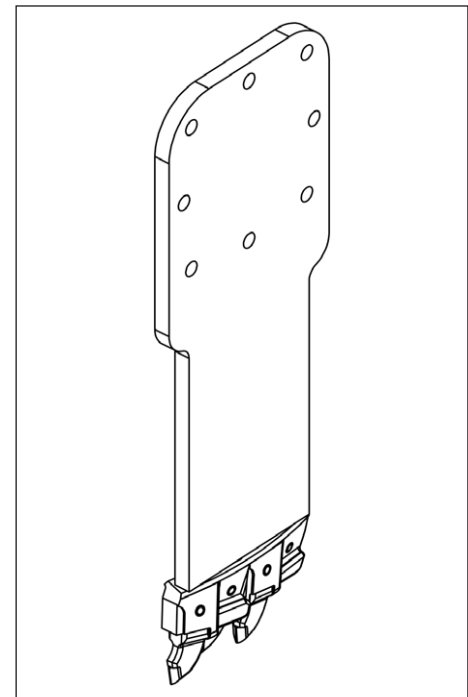

Figure 30. Water Valve Cutting Blade

Mr. Valve Centering Cone & Reducer Ring

Part Number: K-MM0173

Weight: 88 lbs.

Parts also sold separately:

P-MM0174 - Mr. Valve Centering Cone

P-MM0175 - Mr. Valve Center Cone Reducer Ring

The Centering Cone and Reducer Ring is used for cutting out water valve boxes. The Guide Shaft of the Six Shooter is inserted into the Centering Cone to center the Six Shooter for cutting out the valve box.

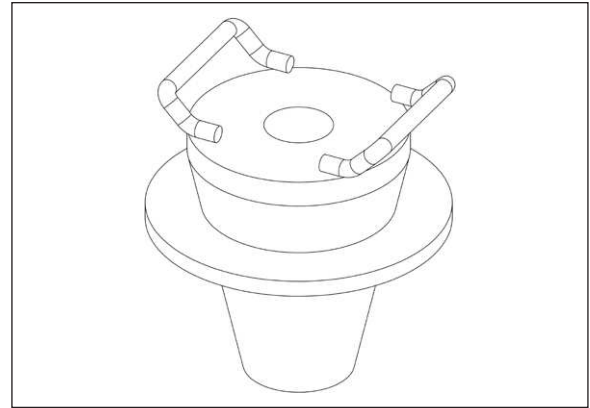

Figure 32. Mr. Valve Centering Cone & Reducer Ring

Mr. Valve Blaster Unit

Not part of the Water Valve Rebuild Package

Part Number: A-MM0480

Weight: 95 lbs.

For valve boxes that can't be pulled, the Blaster Unit is used after the cut is made to break apart the top portion of the valve box. The Blaster Unit is sized so that it will not go into the smaller-diameter valve tube under the valve box. Use with a mini-excavator or a skid steer loader to power its hydraulics.

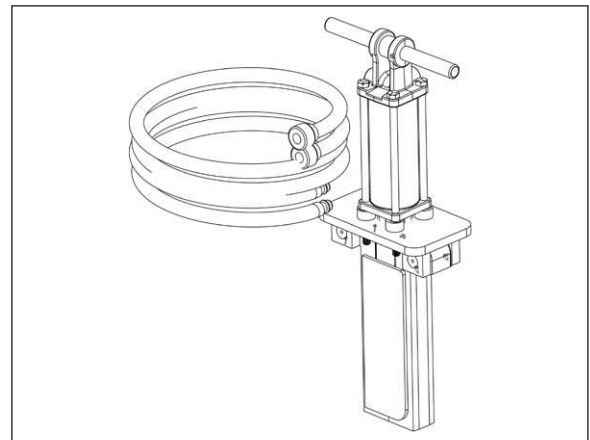

Figure 33. Mr. Valve Blaster Unit Assembly

6" Extended Blade - Platinum (Teeth Included)

Part Number: A-MM0422

Weight: 31 lbs.

The Extended Tooth Blades add up to six inches in cutting depth and are designed to be used with the Extended Guide Shaft.

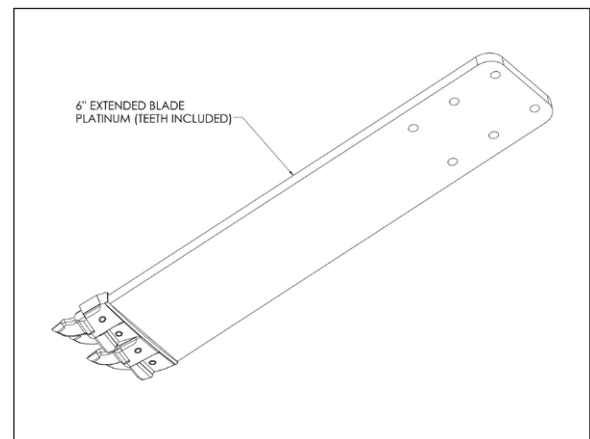

Figure 34. 6" Extended Blade - Platinum

Lifting Device

Part Number: P-MM0344

Weight: 15.5 lbs

The Lifting Device is used when the cutting and the lifting operations are not performed at the same time, or when cutting and lifting operations are divided between two crews. The Lifting Device has a pin that is designed to fit through the keyhole in the Speedplate and is used to pull the casting and overcut out while the Six Shooter remains attached to another machine.

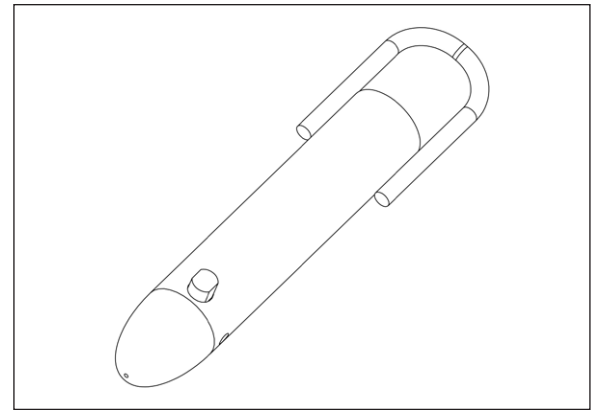

Figure 35. Lifting Device

Newcon Plate, Pipe Guide And T-Stop

The Newcon system is used to repair manhole chimneys in conjunction with new construction or road rebuilding.

Newcon Plate 3/8" [P-MM0193] 117 lbs.

Newcon Plate 1/4" [P-MM0588] 78 lbs.

Pipe Guide [P-MM0589] 1.5 lbs.

T-Stop [K-MM0563] 1.7 lbs.

After the manhole chimney and cover have been removed, the steel Newcon Plate is placed on the manhole cone at dirt level and the road surface is rebuilt, covering the plate.

Visit the Video Resources section of

www.mrmanhole.com for training instructions for use of the Newcon system.

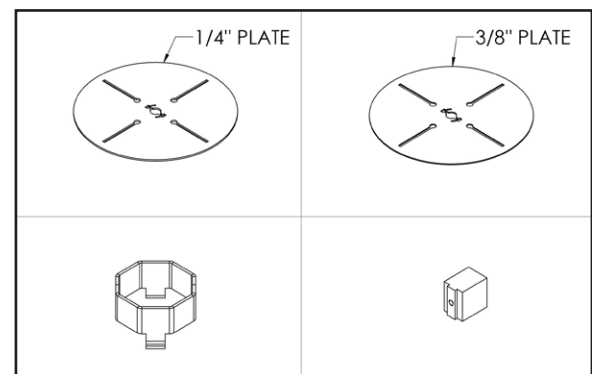

Figure 36. Newcon Plates, Pipe Guide And T-Stop

Newcon Auger

Part Number: A-MM0194

Weight: 33.5 lbs

After the road has been surfaced, the Newcon Auger is attached to the guide shaft of the Six Shooter and used to drill down to the previously placed Newcon Plate. After the cut, the Six Shooter is used to lift the steel plate and overcut out and the manhole is finished using the standard Mr. Manhole method.

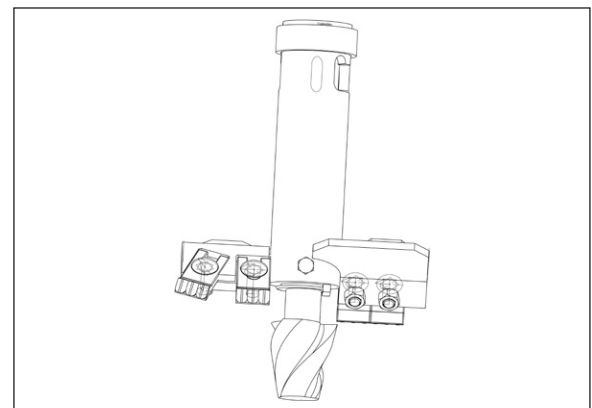

Figure 37. Newcon Auger

Product Registration Form

Please complete the Product Registration Card and return WITH ORIGINAL PURCHASE RECEIPT to Mr. Manhole at 125 S. Canal St., Delphos, OH 45833 by mail WITHIN 30 DAYS OF PURCHASE in order to validate this warranty. You can also register on our website www.mrmanhole.com.

For Parts and Customer Service, please call 567-242-2221, fax 419-692-1600 or email info@mrmanhole.com

Business Name: _____

Name (Last, First): _____

Street Address: _____

City: _____ State: _____ Zip: _____

Phone: _____

Platinum Series Six Shooter: Serial Number* _____

I have received the training material included with my product(s) and have reviewed such material as to operate the equipment safely in its intended manner.

Signature: _____

Place of Purchase: _____ Date of Purchase: _____

* The serial number for the Platinum Series Six Shooter is located inside the main disc of the Six Shooter along the side, where the cutting arms slide in and out. The serial number is also included with your paperwork.

See Our Training Videos
By Scanning Below.



Phone: 567-242-2221

Fax: 419-692-1600

Email: info@mrmanhole.com

Website: www.mrmanhole.com

Address: 125 S Canal St.
Delphos, OH 45833